

G2 SERIES INTRINSICALLY SAFE

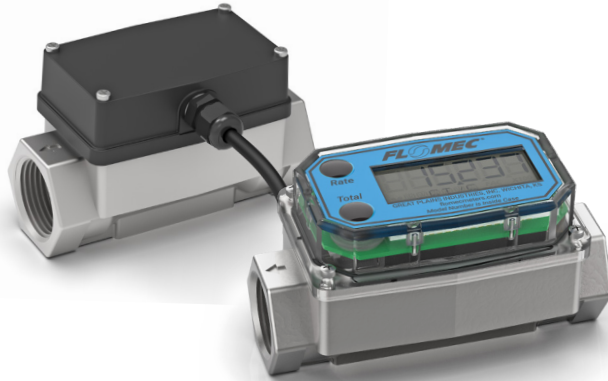

SPECIFICATIONS

Fitting Type:	NPT or ISO (Female) BSPT (ISO 7 designation is RC)				
	150# ANSI (S10, S15 y S20 only)				
	Tri-Clamp (Stainless Steel only) - Fitting size is one size bigger than meter size				
Meter Sizes Available:	1/2"	3/4"	1"	1-1/2"	2"
Corresponding Tri-Clamp Fitting:	3/4"	1"	1-1/2"	2"	2-1/2"
Housing Material:	316 Stainless Steel, Aluminum, PVDF				
Flow Range:	1/2" (05)	1 - 10 GPM		(3.8 - 38 L/min)	
	1/2" (05) <i>PVDF Only</i>	1.2 - 12 GPM		(4.5 - 45 L/min)	
	3/4" (07)	2 - 20 GPM		(7.6 - 76 L/min)	
	1" (10)	5 - 50 GPM		(19 - 190 L/min)	
	1-1/2" (15)	10 - 100 GPM		(38 - 380 L/min)	
	2" (20)	20 - 200 GPM		(76 - 760 L/min)	
Accuracy (% of Reading):	Turbine Only			Turbine w/Computer	
	1/2" (05)	± 2.0%		± 1.5%	
	3/4" (07)	± 1.5%		± 1.0%	
	1" (10)	± 1.5%		± 1.0%	
	1-1/2" (15)	± 1.0%		± 0.75%	
	2" (20)	± 1.0%		± 0.75%	
Repeatability:	± 0.1% (PVDF is ± 0.3%)				
Pressure Rating:					
Stainless Steel 316 SS	1,500 psi (102 bar)				
Aluminum	300 psi (21 bar)				
ANSI Flange 316 SS	Flange Rule				
Sanitary Flange 316 SS	Limited by fitting, clamp size, & temperature				
PVDF	100 psi (6.9 bar)				
Operating Temperature Range:	-40° F to 250° F (-40° C to 121° C)				
	(PVDF) -20° F to 180° F (-28° C to 82° C)				
with Intrinsically Safe Display:	0° F to +129° F (-18° C to +54° C)				
Typical K-Factor:	1/2" (05)	2,500 PPG (660 Pulses/L)			
	3/4" (07)	1,100 PPG (291 Pulses/L)			
	1" (10)	565 PPG (149 Pulses/L)			
	1-1/2" (15)	215 PPG (57 Pulses/L)			
	2" (20)	100 PPG (26 Pulses/L)			

A full line of **FLOMEC® G2 Series Turbine Meters** are available in a variety of housing materials. Rugged and dependable, the G2 Series offers:

- Stainless Steel for most water and chemical products
- Aluminum for fuels and petroleum-based products
- PVDF for aggressive chemicals

FEATURES / BENEFITS

- Meter is designed for thin fluids < 100 cP
- Modular design allows for use with Output Modules, Sensors and Remote Display Kits
- 2 Totals (Batch Total = Resettable, Total = Non-Resettable); Rate of Flow, Factory calibrated in gallons or litres. Field calibratable. Includes non-volatile totals.
- High accuracy meter
- Internal parts are simple to replace for easy maintenance
- AAA Alkaline battery life: 2 years

APPLICATIONS

- Batching
- Blending
- Water
- Industrial fluids
- Plating solutions
- Ammonium
- Food and beverage processing
- Fuel products
- Monitoring clean fluids
- Plant process water
- Chemical feed lines
- Harsh chemicals (sulfuric acid and bleach)
- DEF (Diesel Exhaust Fluid)

APPROVALS[†]



IP65



ISO 22241-2 Annex C, D, E, F, G, H, I, Diesel Exhaust Fluid (DEF)/Adblue standards

[†]If the meter includes any modules (4-20 mA and Pulse Out) that introduces external power or adds the high temp riser, then all intrinsic safety approvals are voided.



G2 SERIES

INTRINSICALLY SAFE

SPECIFICATIONS (CONTINUATION)

Wetted Materials:	Housing:	316 Stainless Steel or Aluminum
	Bearings:	96% Alumina Oxide Ceramic
	Shaft:	Tungsten Carbide
	Rotor:	PVDF
	Rings:	316 Stainless Steel
Wetted Materials PVDF:	Housing:	PVDF (15% Carbon Fiber Filled)
	Bearings & Shaft:	98% Alumina Ceramic
	Rotor:	PVDF
	Rings:	Fluorocarbon (Optional PTFE)
Frequency Range:	1/2" (05)	42-420 Hz @ 1-10 GPM (3.8-38 L/min) / 45-450 Hz @ 1.2-12 GPM (4.5-45 L/min) (PVDF)
	3/4" (07)	37-370 Hz @ 2-20 GPM (7.6-76 L/min)
	1" (10)	47-470 Hz @ 5-50 GPM (19-190 L/min) / 45-475 Hz @ 5-50 GPM (19-190 L/min) (PVDF)
	1-1/2" (15)	36-360 Hz @ 10-100 GPM (38-380 L/min)
	2" (20)	33-330 Hz @ 20-200 GPM (76-760 L/min)
Calibration Report:	Comes standard with G2 Series meters.	
	N.I.S.T. – Certification available.	

ACCESSORIES

Part No.	Description
125100-10	4-20Ma / Pulse Output Module
125260-02	90° Display Adaptor Kit
113275-10	FM Approved Remote Kit
125206-2	1/2 in. Teflon O-Ring for PVDF Meter (2)
125206-1	1 in. Teflon O-Ring for PVDF Meter (2)

DIMENSIONS NOTE: Q9 Display adds 0.72 in. (18 mm) to height

Stainless Steel Models

	S05, ½ in.	S07, ¾ in.	S10, 1 in.	S15, 1½ in.	S20, 2 in.
A = Height	1.4 in. (35.6 mm)	1.6 in. (40.6 mm)	1.9 in. (48.3 mm)	2.6 in. (66.0 mm)	3.1 in. (78.7 mm)
B = Width	2.0 in. (50.8 mm)	2.0 in. (50.8 mm)	2.0 in. (50.8 mm)	2.7 in. (68.6 mm)	3.4 in. (86.4 mm)
C = Length	4.2 in. (106.7 mm)	4.3 in. (109.2 mm)	4.5 in. (114.3 mm)	5.3 in. (134.6 mm)	6.3 in. (160.0 mm)

Aluminum Models

	A05, ½ in.	A07, ¾ in.	A10, 1 in.	A15, 1½ in.	A20, 2 in.
A = Height	1.8 in. (45.7 mm)	2.0 in. (50.8 mm)	2.2 in. (55.9 mm)	2.8 in. (71.1 mm)	3.2 in. (81.3 mm)
B = Width	2.0 in. (50.8 mm)	2.0 in. (50.8 mm)	2.0 in. (50.8 mm)	2.7 in. (68.6 mm)	3.3 in. (83.8 mm)
C = Length	4.2 in. (106.7 mm)	4.3 in. (109.2 mm)	4.5 in. (114.3 mm)	5.3 in. (134.6 mm)	6.3 in. (160.0 mm)

PVDF Models

	P05, ½ in.	P10, 1 in.
A = Height	3.2 in. (81.3 mm)	3.3 in. (83.8 mm)
B = Width	2.1 in. (53.3 mm)	2.8 in. (71.1 mm)
C = Length	7.3 in. (185.4 mm)	8.1 in. (205.7 mm)

NOTE: For representation purpose only. Actual product models vary in shape, design, etc

ANSI Flange and Sanitary Flange dimensions not shown. For those dimensions, please refer to product manuals or our website FLOMECmeters.com.

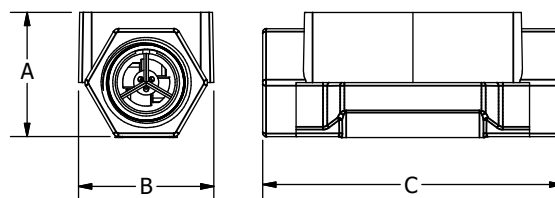

Accu-Flo
1-800-921-2228
www.accuflo.com